



*jordan fishwick*

Lynton Court Lynton Lane, SK9 7NP  
Guide Price £295,000



## Lynton Lane Alderley Edge SK9 7NP

Guide Price £295,000



NO CHAIN. Set within a prime central Alderley Edge position, this well-presented ground floor apartment combines convenience, comfort and the advantage of no onward chain. Positioned within easy reach of the village's vibrant selection of boutiques, cafés, restaurants and amenities, this two-bedroom apartment is perfectly suited to those seeking convenient, single-level living in a highly desirable setting. The apartment comprises in brief, a communal entrance hallway, private hallway with handy storage cupboards and access to all aspects of the accommodation. The apartment is thoughtfully arranged, featuring a bright lounge/dining room to the front aspect, enhanced by an attractive bay window. This living space has the added advantage of access to the private and exclusive, covered, front patio area. The adjoining kitchen offers modern wall and base units with complimentary worktop surfaces and a handful of integrated appliances. The apartment boasts two spacious double bedrooms both being served by the a three-piece white family bathroom suite. Externally, residents can enjoy the well-kept communal gardens and resident parking. A private garage is also situated to the rear. Viewing is highly recommended to appreciate the location and convenience this apartment has to offer. Some of the photos have been digitally staged to show space and the potential the property has.



- No Chain
- Ground Floor Apartment
- Two Double Bedrooms
- Prime Alderley Edge Location
- Private Garage
- Open plan Lounge/Diner
- Exclusive Patio Area



Energy Efficiency Rating		
	Current	Potential
Very energy efficient - lower running costs		
(92 plus) <b>A</b>		
(81-91) <b>B</b>		
(69-80) <b>C</b>		
(55-68) <b>D</b>	60	66
(39-54) <b>E</b>		
(21-38) <b>F</b>		
(1-20) <b>G</b>		
Not energy efficient - higher running costs		
<b>England &amp; Wales</b>	EU Directive 2002/91/EC	

## GROUND FLOOR

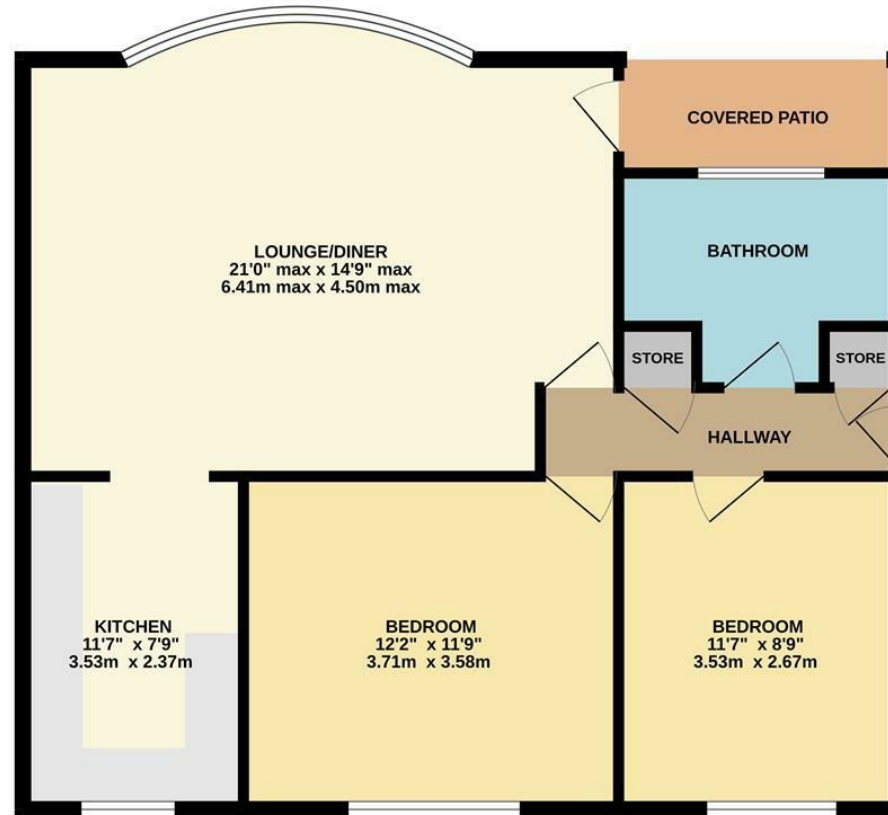

Measurements are approximate. Not to scale. Illustrative purposes only.  
Made with Metropix ©2025



These particulars are believed to be accurate but they are not guaranteed and do not form a contract. Neither Jordan Fishwick nor the vendor or lessor accept any responsibility in respect of these particulars, which are not intended to be statements or representations of fact and any intending purchaser or lessee must satisfy himself by inspection or otherwise as to the correctness of each of the statements contained in these particulars. Any floorplans on this brochure are for illustrative purposes only and are not necessarily to scale.

Offices at: Chorlton, Didsbury, Disley, Hale, Glossop, Macclesfield, Manchester Deansgate, Manchester Whitworth Street, New Mills, Sale, Wilmslow and Withington

36-38 Alderley Road, Wilmslow SK91JX  
**01625 532000**

wilmslow@jordanfishwick.co.uk  
www.jordanfishwick.co.uk